

Connection kit	With this interlocking kit, two compressed air instruments can be connected to one another without need for double nipples. This makes possible very compact layouts.
C35 :	<ul style="list-style-type: none"> Mounting using rotary clip and two o-rings. These allow regulators to be connected to other regulators or filters.
C40 :	<ul style="list-style-type: none"> Instruments are connected to each other using screws, nuts and o-ring; alternatively, a segmented connecting block can be used for instrument connection.
C50 :	<ul style="list-style-type: none"> Instrument connection by means of a two-part connecting block.
Branch plate	
C40 :	<ul style="list-style-type: none"> Branch plate with compressed air connection port G$\frac{1}{8}$ or G$\frac{1}{4}$ or both outlet plates. Supply plate for two pressure regulators through port G$\frac{1}{4}$.
C50 :	<ul style="list-style-type: none"> Branch plate with compressed air connection G$\frac{1}{4}$. Port installation of the branch plate is only possible using connecting blocks.

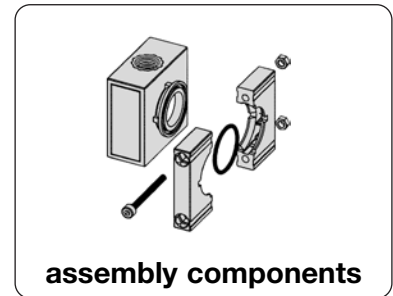

Description	Connection of instruments	for series	Order number
-------------	---------------------------	------------	--------------

Connection kit	for connecting separate instruments	C...	
rotary clips with two o-rings screws, nuts and o-ring	R+F or R+R or F+F	35	C350100018
	F+R+L or P+B+L	42	C400500001
	B+L	42	C400600001
	F+L or F+F	42	C400700001
connection kit	for any two instruments	42	C420600001
		50 / 52	C500600001
		75	C750600001
		80	C800600004
		95	C950600001

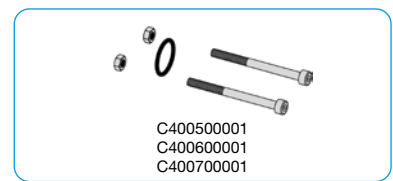

Branch plate	with compressed air connection port	C...	
outlet G $\frac{1}{8}$		42	C400500102
outlet G $\frac{1}{4}$		42	C400500108
outlet G $\frac{1}{8}$ and G $\frac{1}{4}$		42	C400500103
outlet G $\frac{1}{8}$ and G $\frac{1}{4}$	with connection kit	42	C420500003
supply G $\frac{1}{4}$ for two regulators		42	C400500111
outlet G $\frac{1}{4}$		50 / 52	C500500003
outlet G $\frac{1}{4}$		75	C750600002
outlet G $\frac{1}{4}$		80	C800600005

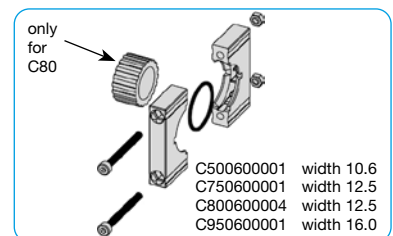
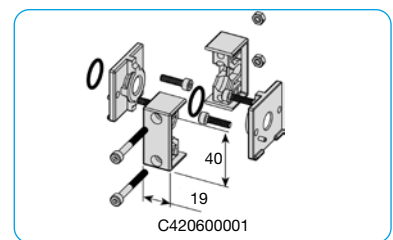

Mounting material			C...
mounting bracket		for G $\frac{1}{4}$	BW30-01
mounting bracket		for G $\frac{3}{8}$ to G $\frac{1}{2}$	BW42-01
wall mounting		for G $\frac{1}{4}$	C420500001
wall mounting		for G1	C950100018
bracket holder	required in absence of C9506	for G1	C950100015

